

ADLER Brilliantalkyd

52301 ff

Glossy, solvent-based **synthetic resin topcoat for indoor and outdoor use on wood and metal for DIY and professional use**

PRODUCT DESCRIPTION

General

Universally usable, glossy, solvent-based synthetic resin topcoat (conforms to VOC Decopaint 2010). Good resistance to weathering and yellowing as well as having high gloss retention power. The product is characterized by quick drying, good scratch-resistance, high covering power and filling power as well as optimal flow and good sag resistance. Environmentally friendly due to a higher solid content and white spirits free of aromatic hydrocarbons as solvent. Low-odour.

Application areas

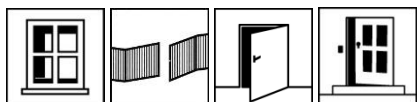

- For the coating of wood and metal indoors and outdoors.
- The product is not suitable for interior surfaces of furniture and cabinets due to possible odour nuisance.

PROCESSING

Instructions for use



Spraying is only allowed in spray booths complying with the VOC Directive.

- Please stir the product before use.
- Do not apply if temperatures are below 5 °C or higher than 30 °C and/or relative humidity > 80%.

Application technique

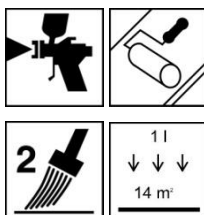

Application method	Brushing	Rolling	Cup gun
Spraying nozzle (Ø mm)	-	-	1.8 - 2
Spraying pressure (bar)	-	-	2 – 2.5
Dilution (thinning)	-	-	KH-Spritz-Verdünnung 80367
Thinner amount added in %	-	-	20
Yield per application (m ² /l) ¹⁾	approx. 14		approx. 11
¹⁾ Yield including addition of thinner and loss while spraying			

The shape, the properties and moisture of the substrate affect the consumption/yield. Accurate values for consumption must be obtained by applying trial coats in advance.

Drying times

(at 23 °C and 50 % rel. humidity)

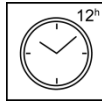

Dust-dry (ISO 1517)	after approx. 2–3 hours
Tack-free	after approx. 5–6 hours
Recoatible	after approx. 12 hours

The figures given above are reference values. The drying time depends on the type of substrate, coat thickness, temperature, air exchange and relative atmospheric humidity.

For good thorough drying, the recommended application quantities must be adhered to. Excessive layer thicknesses lead to a considerable drying delay!

Cleaning the working equipment

With ADLER Adlerol aromatenfrei 80301.

SUBSTRATE**Type of substrate**

Wood, wooden materials, metal as well as hard PVC

Substrate property (or condition)

The substrate must be dry, clean, capable of holding the paint, free from separating substances such as grease, wax, silicone, resin etc. and free from wood dust, as well as tested for suitability for coating.

Please observe and follow ÖNORM B 2230 Part 2.

See also VOB, Part C, DIN 18363, Paragraph 3; painting and coating work.

Any coatings that cannot be recoated must be removed thoroughly.

Wood moisture

Hardwoods: 12 % +/- 2 %

Softwoods: 15 % +/- 2 %.

Preparation of the substrate**Wood and wood-based materials**

Round off any sharp edges, remove wood extractives such as, for example, resins and pitch pockets.

Iron and steel

Remove rust down to bare metal.

Thoroughly remove greasy or oily impurities using ADLER Entfetter (degreaser) 80394.

Zinc, aluminium and other non-ferrous metals

Sand until matt with grinding fleece and ADLER Entfetter 80394.

Synthetic materials

Grind with abrasive fleece.

Old coatings

Sand and clean intact old coatings with grit size 120.

Please observe the relative technical data sheets of the products.

COATING SYSTEM

Primer coat**Wood and wood-based materials**

1 x ADLER Alkyd-Grund 54063

To begin with, apply 1 coat of Pullex Imprägnier-Grund (impregnation primer) 4436000200 using a brush to raw softwoods or wood used outdoor that is sensitive to fungus.

Iron and steel

Indoors:

1 x ADLER Metallgrund 54033 ff or ADLER Unigrund LM 54065 ff

Outdoors:

2 x ADLER Metallgrund 54033 ff or ADLER Unigrund LM 54065 ff

Zinc

2 x ADLER Unigrund LM 54065 ff or ADLER 2K-Epoxi-Grund 68304

Aluminium and other non-ferrous metals

1 x ADLER Unigrund LM 54065 ff or ADLER 2K-Epoxi-Grund 68304

Sand anodised aluminium and stainless steel very well until matt and prime within 60 minutes with ADLER 2K-Epoxi-Grund 68304.

Synthetic materials

1 x ADLER Unigrund LM 54065 ff or ADLER 2K-Epoxi-Grund 68304

Due to the high number of plastics, an adhesion test is recommended.

Old coatings

The compatibility of the paint must be tested on old coatings.

For powder coatings we generally recommend priming with ADLER 2K-Epoxi-Grund 68304. Make a sample and check adhesion. Please observe BFS data sheet no. 24.

Please observe the relative technical data sheets of the products.

Intermediate sanding

Grit size 240

Remove the wood dust.

Intermediate coat

1 x ADLER Brilliantalkyd 52301 ff

Intermediate drying: approx. 12 hours

Final coat

1 x ADLER Brilliantalkyd 52301 ff

MAINTENANCE AND RENOVATION

Maintenance and renovation

The durability depends on several factors. These include particularly the type of weathering, constructional protection, mechanical stress and the choice of colour applied. To obtain long durability, preservation work is necessary in time. Therefore, we recommend annual maintenance.

If required, remove dust and dirt from the still intact areas and paint once with ADLER Brilliantalkyd 52301 ff.

Please observe the relative technical data sheets of the products.

Please follow our **“Working guideline for coating non-dimensionally stable and limited dimensionally stable construction elements.”** **Balconies – Canopies – Timber cladding – Wooden houses / Maintenance and Renovation.”**

ORDERING INFORMATION

Size of trading unit

125 ml; 375 ml; 750 ml; 2,5 l

Color shades/degree of gloss

Weiß W10	52301	Moosgrün RAL 6005	52317
Rapsgebl RAL 1021	52311	Nussbraun RAL 8011	52320
Verkehrsrot RAL 3020	52312	Tiefschwarz RAL 9005	52322
Feuerrot RAL 3000	52313	Silbergrau RAL 7001	52323
Enzianblau RAL 5010	52314	Lichtgrau RAL 7035	52324
Laubgrün RAL 6002	52316	Cremeweiß RAL 9001	52325



Other colour shades can be obtained using the **ADLER colour mixing system Color4You.**

Base paints:

Weiß W10	52301	Base W30	52304
Base W15	52300	Basisgelb	52305
Base W20	52302	Basisrot	52306

- In order to ensure uniformity of the colour shade, use only material having the same batch number on a given surface.
- It is recommended to prepare a trial colour sample on the original substrate using the coating system selected in order to assess the final colour shade.
- White and shades derived from white tend to change the colour tone in artificial lighting. This appearance typical of synthetic resin paints can be reinforced by dark storage and ammonia-containing air.

Supplementary products

ADLER Adlerol aromatenfrei 80301
 ADLER KH-Spritzverdünnung 80367 (spraying application)
 ADLER Alkyd-Grund 54063 (wood)
 ADLER Metallgrund 54033 ff (metal)
 ADLER Unigrund LM 54065 ff
 ADLER 2K-Epoxi-Grund 68304
 ADLER Entfetter 80394
 Pullex Imprägnier-Grund 4436000200 (wood)

FURTHER DETAILS

Durability / Storage

At least 3 years in the original sealed containers.

We recommend that you transfer the contents of open containers to smaller ones in order to prevent gelling / skin formation.

Technical specifications

VOC content EU threshold for ADLER Brilliantalkyd (Cat. A/d):
300 gm/l (2010). ADLER Brilliantalkyd contains a
maximum of 300 g/l VOC.

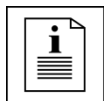
Safety-related information

Please pay attention to the associated safety data sheet. The current version can be accessed on the Internet at www.adler-lacke.com.

Inhaling paint aerosols whilst spraying must generally be avoided; this is ensured by correctly using a respiratory mask (combination filter A2/P2 – EN 141/EN 143).
