

ADLER Formel 2000

40205 ff

High-quality **blendable living room paints** for **DIY and commercial end uses**

PRODUCT DESCRIPTION

General

White or blendable, having good breathing properties and water-based indoor paint for wall and ceiling coats. The product with very high yield and easy to use is free of solvents and non-plasticized and thus, odourless.

Special Properties and standards



- Free from active fogging substances
- High level of diffusion in accordance with DIN EN 52615
- **OENORM EN 13300**
Wet abrasion resistance: Class 2
Contrast ratio (Covering power): Class 1 (at 7 m²/l)
Degree of gloss: dull matt
Maximum grain size: fine (< 100 µm)
- **French ordinance DEVL1104875A** regarding the marking of construction coating products for their emission of volatile pollutants: A+
- Awarded the Austrian Eco Label

Application area



For all white or coloured indoor wall and ceiling paints. It is particularly suitable for living rooms, bedrooms, children's rooms, offices, hospitals, medical treatment homes, schools, etc., which need to be covered up again quickly. In most cases, one coat suffices particularly for refurbishment on account of the high covering power.

PROCESSING

Instructions for use

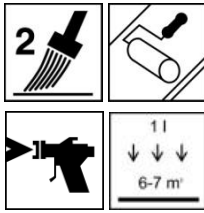

- Please stir the product before use.
- Do not apply it at temperatures below + 8 °C and / or relative atmospheric humidity > 80 %.
- Apply the coat at one stroke to avoid wet-on-wet crusts.
- Signs of touch-up work on the surface depend on several factors and hence, cannot be avoided (BFS data sheet 25).
- Do not recoat permanently elastic joint masses and sealing weather strips (may lead to formation of cracks or fading of the coat)!
- Remove paint splashes with water immediately.

Application technique

Application method	Using a brush	Roller brush application	Airless Air-supported (Air mix, air coat, etc.)
Spray nozzle (Ø mm)	-	-	0,53 – 0,63
Spray nozzle (Ø inch)	-	-	0,021 – 0,026
Nozzle angle (°)	-	-	50
Spraying pressure (bar)	-	-	150 – 180
Fine strainer	-	-	0.2 mm
Dilution (thinning)	Water		
Thinner amount added in %	Maximum 5		
Consumption ml/m ²	approx. 150		
Yield per application (m ² /l) ¹⁾	approx. 7	approx. 6	
¹⁾ Yield including addition of thinner and loss while spraying			

The shape and properties of the substrate affect the consumption / yield. Accurate values for consumption must be obtained by applying trial coats in advance.

Drying times

(at 23 °C and 50 % rel. humidity)

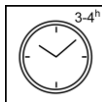

Can be recoated	after approx. 3 – 4 hours
-----------------	---------------------------

The figures indicated serve as a guide and are for reference. The drying time depends on the coat thickness, temperature, air exchange and relative atmospheric humidity.

Low temperatures and / or high atmospheric humidity delay the drying process.

Cleaning the tools and equipment

Clean them with soap water immediately after use.

Remove dried-up paint residues with ADLER Abbezier Rote Krähe 95125.

SUBSTRATE**Type of substrate**

Mineral plasters, gypsum plaster, concrete, gypsum plaster boards and recoatable old coatings.

Substrate property (or condition)

The substrate must be dry, clean and free from any separating substances, and it must be checked to see whether it is suitable and capable of being recoated.

Please observe and follow ÖNORM B 2230 Part 2.

See also VOB, DIN 18363, Part C, paragraph 3; Painting and coating work.

Any coatings that cannot be recoated must be removed thoroughly.

Preparation of the substrate

- Touch up small cracks, holes or unevenness using a suitable wood filler.

- Thoroughly remove greasy or oily impurities using ADLER Entfetter (degreaser) 80394.
- No pre-treatment is necessary for clean, slightly absorbent and dry substrates that can be recoated.
- Treat fungal attack with ADLER SchimmelEx 96349.

Plasters of the mortar groups P II and P III

Allow new plaster application to remain untreated for three to four weeks. Re-plastered patches must be set well and dried up and, if required, seal them with fluosilicate.

On coarsely porous and slightly sanding or absorbent surfaces, apply a primer coat with ADLER Tiefengrund WV 40905 diluted 1:1 with water.

Gypsum and readymade plasters of the mortar groups P IV and P V

Grind off any sintered coat remaining, and apply one primer coat using ADLER Tiefengrund WV 40905 diluted 1:1 with water.

Gypsum plaster boards (GKP)

Grind off wood filler burrs. Apply one primer coat of ADLER Tiefengrund WV 40905 diluted 1:3 with water.

Concrete surfaces

Mechanically clean the surfaces and remove deposits of dirt, separating agents and powder layers. On coarsely porous and slightly sanding or absorbent surfaces, apply a primer coat with ADLER Tiefengrund WV 40905 diluted 1:1 with water.

Coats that can be recoated

Work directly on matt and poorly absorbent coatings. On coarsely porous and slightly sanding or absorbent surfaces, apply a primer coat with ADLER Tiefengrund WV 40905 diluted 1:1 with water.

Apply leaching agents, roughen up or grind glossy or smooth substrates (such as painted and latex substrates, sintered coats

Prevent the ADLER Tiefengrund WV from drying up in glossy condition!

Soft distempers

Wash off thoroughly and apply a primer coat with ADLER Tiefengrund WV 40905 diluted 1:1 with water.

Please observe and follow the data sheets of the respective products.

COATING SYSTEM

Primer coat	See substrate preparation
Intermediate coat	ADLER Formel 2000 40205 ff diluted with max. 5 % water
Final coat	ADLER Formel 2000 40205 ff without thinning or dilution

ORDERING INFORMATION

Sizes of trading unit	750 ml, 3 l, 9 l and 15 l
------------------------------	---------------------------

Colour shades / Degree of gloss**Color4You** 

Weiß (White) W10 40205

Other colour shades can be obtained using the **ADLER colour blending system** (My favourite colour and Color4you).**Base paints:**

Weiß (White) W10 40205

Base W20 40206

Base W30 40207

Basic yellow 40208

Basic red 40209

- In order to ensure uniformity of colour, use material having the same batch number on a given surface.
- It is recommended to prepare a trial colour sample on the original substrate using the coating system selected in order to assess the final colour shade.
- Constrained by the system, lustrous and intensive colour shades have lower covering power under certain circumstances. Hence, it is recommended to apply a preliminary coat of a comparable, white-based pastel colour shade with these colour shades.
- In case of dark colour shades, mechanical stress may lead to bright stripes (writing effect). This is a product-specific characteristic of all matt wall paints. It does not affect the product quality and functionality.

Supplementary products

ADLER Tiefengrund WV 40905

ADLER Abbeizer Rote Krähe 95125

ADLER Entfetter 80394

ADLER SchimmelEx 96349

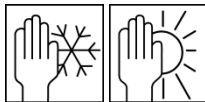
FURTHER DETAILS**Durability / Storage**

At least 1 year in the original sealed containers.

Store it such that it is protected against moisture, direct sunlight, frost and high temperatures (over 30 °C).

Technical Specifications

VOC content

EU limit value for ADLER Formel 2000 (Cat. A/a): 30 gm./l (2010).

ADLER Formel 2000 contains < 1 gm./l VOC.

Product code for paints and varnishes

M-DF01

Safety-related informationPlease follow the associated safety data sheet! The latest version can be retrieved from the Internet at **www.adler-lacke.com**.

Recycle only those containers whose residues have been emptied out. You may dispose of liquid material residues as water-based paint and varnish waste and dried-up material residues as cured paints or as household garbage.